



Regency Court

Newton Abbott, Devon, TQ12

Pathfinder Lighthouse (40x12)



0800 954 1288

sales@sellmygroup.co.uk



£140,000

Stover, Newton Abbott, Devon, TQ12

The Pathfinder Lighthouse bungalow park home is a stunning, simple home featuring practical necessity along with awe inspiring luxury. With a fresh, contemporary look both outside and in, the Lighthouse is a peaceful, relaxing home. The home is perfect for lazy mornings with breakfast-in-bed and the family bathroom is a clean and bright space ideal for visiting guests.

A brand new exclusive development of detached homes, with a 12-month leisure license. It has a wonderful rural location with excellent transport links and nearby shopping and amenities. Set in picture-postcard surroundings, the park has very spaced out and landscaped plots and is tailor made for the over 45s.

Conveniently positioned on the edge of Dartmoor with excellent road links provided by the nearby A38 Devon Expressway. Less than a mile away is Trago Mills Family shopping and Leisure Park as well as the top class Stover Golf Club. Next to the development lies a country park with many and varied walks including a trail through a dramatic valley to Becky Falls.

- Brand new home
- Fully fitted kitchen
- Retirement property
- Over 45s
- Gated and secure community
- Pet-friendly
- 12 month leisure license
- Community living
- Part Exchange available

2x  2x 

**100% Market Value
Part Exchange with
Quickmove Properties**

Home exchange example:

Value of your existing home....£300,000

Price of new park home.....£225,000

Cash for you to enjoy.....£75,000



Floor Plan

Bovey Lane, Newton Abbot, TQ12

Approximate Area = 410 sq ft / 38.09 sq m

For identification only - Not to scale

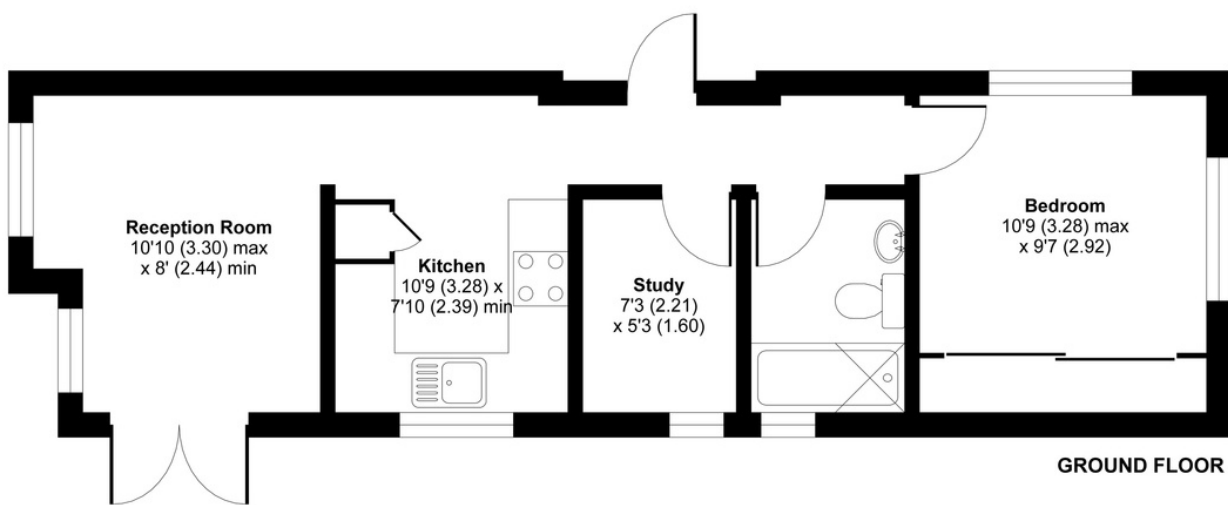

Floor plan produced in accordance with RICS Property Measurement Standards incorporating International Property Measurement Standards (IPMS2 Residential). © rñhecom 2021. Produced for Royale Group Management Company Limited. REF: 686744

CONTACT DETAILS

0800 954 1288

sales@sellmygroup.co.uk

