



# Meadowlands Court

Bude, Cornwall, EX23

Pemberton Rivington (45x14)



0800 954 1288

[sales@sellmygroup.co.uk](mailto:sales@sellmygroup.co.uk)



# £200,000

*Bude, Cornwall, EX23*

The Pemberton Rivington bungalow style park home features an open plan entrance to the kitchen/diner with integrated appliances and dining table with four chairs. The vaulted ceiling continues into the living room which features a matching coffee table and tv unit as well as a sofa and accent chair. The master bedroom features a double bed with bedside tables and wardrobe space. The second bedroom features single beds, perfect for guests to use.

In stunning surroundings and within a mile of the lovely seaside resort of Widemouth Bay, the location is ideal for making the most of glorious coastlines, offering wonderful walks, vast sandy landscapes, and unforgettable sunsets. An excellent base for exploring the many treasures of the Cornish coastline, the town of Bude is only 3 miles away, where you will find all you need in this bustling Cornish town.

Bude has once again been named as the Best UK Coastal Town for three consecutive years, winning a section of Gold, Silver and Bronze awards in the British Travel Awards. Just a stone's throw from the Devon border, epic, wild beaches and a thriving cultural hub await.

- Brand new home
- Community Living
- Fully Fitted Kitchen
- Fully Furnished
- Luxury 2 Bed Park Bungalow
- On Site Facilities
- Parking Space
- RoyaleLife development
- Residential Park

2 x  2 x 

**100% Market Value Part  
Exchange with  
Quickmove Properties**

Home exchange example:

Value of your existing home....£300,000

Price of new park home.....£225,000

Cash for you to enjoy.....£75,000

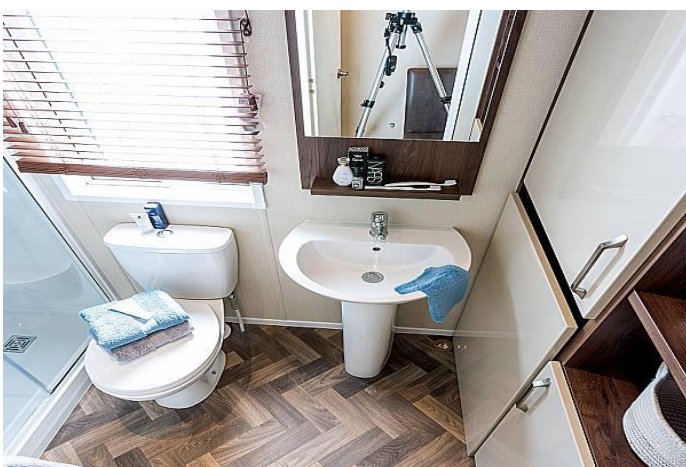

Please note: Stock images have been used, the home on site may vary.

# Floor Plan

Rivington 42ft x 14ft • 2 bedroom

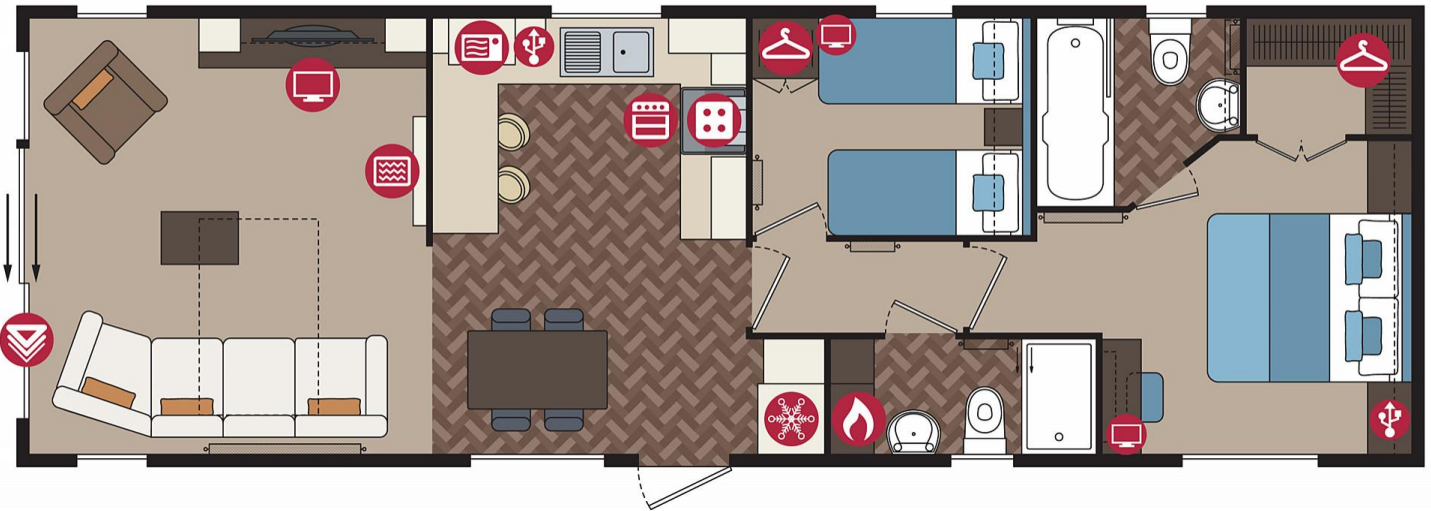

## CONTACT DETAILS

0800 954 1288

[sales@sellmygroup.co.uk](mailto:sales@sellmygroup.co.uk)

