



New Forest Glades

Christchurch, Dorset, BH23



0800 954 1288

sales@sellmygroup.co.uk



£190,000

New Forest, Christchurch, Dorset, BH23

This brand new, modern-furnished Summerhouse luxury park home is perfect for those looking for a detached, easy to maintain, bungalow style retirement property. The interior design is warm and inviting with comfortable sofa and open plan kitchen/dining room. The home has two double bedrooms and two bathrooms.

This home is set on a brand new bungalow development, within the beautiful location of Hurn, close to Christchurch, Dorset. This park is made up of a safe and welcoming community, designed exclusively for the over 45s. Pets are welcome.

This stunning development offers easy access to the neighbouring towns of Bournemouth and Poole, as well as surrounding country parks including the New Forest and Moors Valley Country Park which offer wonderful walking trails.

Everything you could need is on your doorstep at New Forest Glades from the local shop which is less than a mile away, to the GP surgery only 3 miles away. There are also excellent transport links nearby with the train station only 4 miles away and the bustling town of Bournemouth less than 25 minutes' drive away.

- Brand new home
- Community Living
- Countryside location
- Fully Furnished
- Integrated Appliances
- New Development
- Over 45's
- Part Exchange Available
- Pets welcome

2 x  2 x 

100% Market Value Part Exchange with Quickmove Properties

Home exchange example:

Value of your existing home.....	£300,000
Price of new park home.....	£225,000
Cash for you to enjoy.....	£75,000



House
To Sell?

100% Market Value Home Part-Exchange
available at this development

Quickmove
PROPERTIES

NO HASSLE • NO FEES • NO DELAYS

Please note: Stock images have been used, the home on site may vary.

Floor Plan

THE WENTWOOD SINGLE 46' x 14'

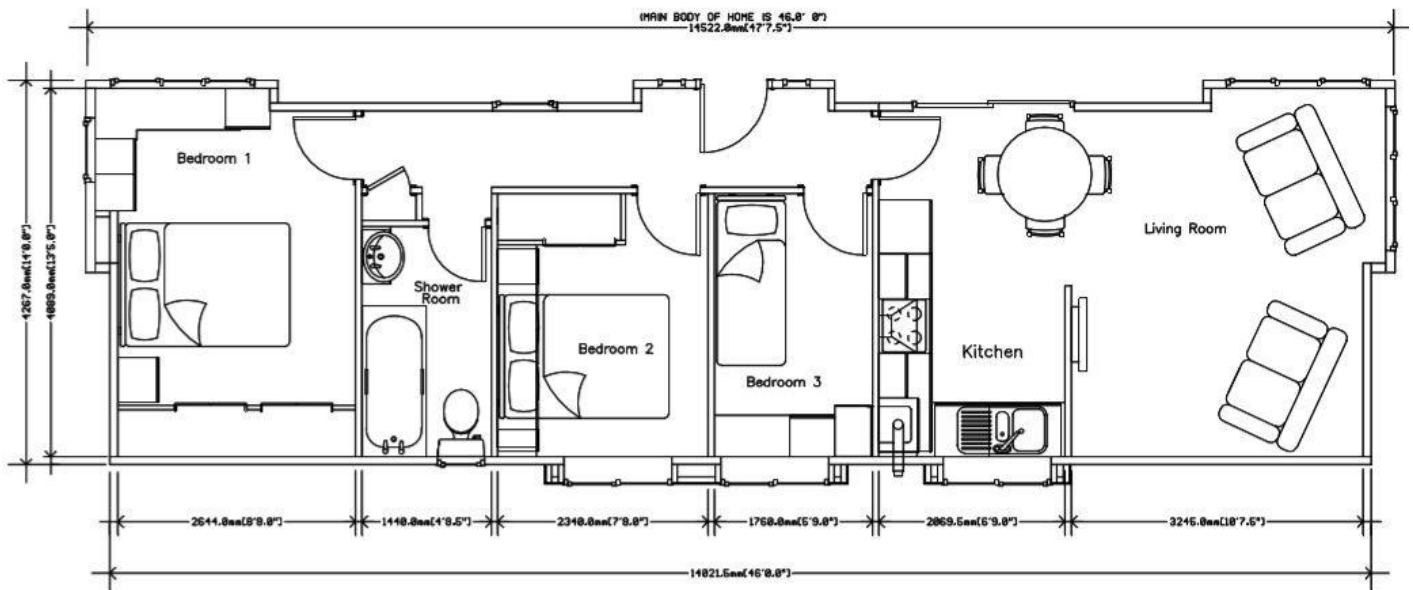

CONTACT DETAILS

0800 954 1288

sales@sellmygroup.co.uk

