

Evesham, Worcestershire, WR11



£324,950



This brand new, modern-furnished Stately Kensington luxury park home is perfect for those looking for a detached, easy to maintain, bungalow style retirement property. The landscaped exterior boasts a covered welcome porch, garden area and 2 paved parking spaces.

Set at the foot of Bredon Hill, near the market towns of Evesham, Pershore and historic Tewkesbury where the rivers Severn and Avon meet alongside one of the finest abbeys in the country. Other places of interest are Broadway, Moreton in Marsh, Stow on the Wold, Cheltenham Spa and Shakespeare's Stratford. These are all just a short drive away. Activities in the area include golf, swimming, squash, horse riding, rowing, tennis courts, croquet and bowling green, sailing or just enjoy walking across Bredon Hill.

Age restriction: Over 50's

Pet friendly: Yes

Site fees: £135 per month

Residential license

Stock image have been used, the home on site may vary.

## Key Features

- Family owned park
- Fully furnished
- Over 50's
- Part exchange available
- Community living
- Pet-friendly
- Retirement property
- Rural location
- Shops and amenities nearby
- Fitted kitchen

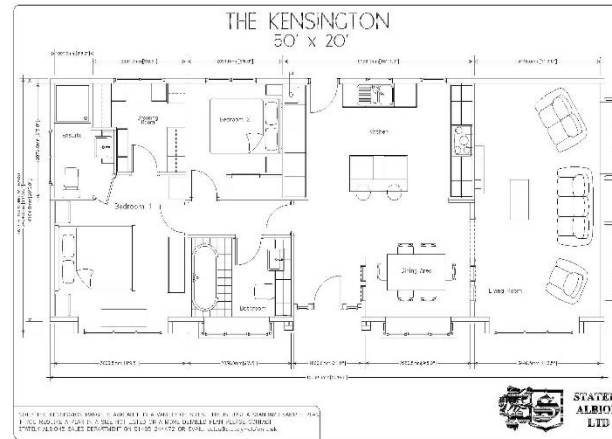

### House to sell?

Hassle-free Property Part-Exchange is available from Quickmove Properties, with no estate agent fees, no solicitor's fees and no market uncertainty.

## CONTACT US

01793 840917

advice@quickmoveproperties.co.uk

**Quickmove**  
PROPERTIES

