

Evesham, Worcestershire, WR11

Quickmove  
PROPERTIES



£360,000



This brand new, modern-furnished luxury park home (55x22) is perfect for those looking for a detached, easy to maintain, bungalow style retirement property. This home features vaulted ceilings, bi-fold doors, and a modern fully fitted kitchen with integrated appliances, two good sized bedrooms and two bathrooms.

Set at the foot of Bredon Hill and not too far from the small market towns of Evesham, Pershore and historic Tewkesbury. Other places of interest are Broadway, Moreton in Marsh, Stow on the Wold, Cheltenham Spa and Shakespeare's Stratford. These are all just a short drive away. Activities in the area include golf, swimming, horse riding, tennis courts, croquet and bowling green, sailing or just enjoy walking the many footpaths across Bredon Hill.

Age restriction: Over 50's

Pet friendly: Yes

Site fees: £135 per month

Residential license

Stock images have been used, the home on site may vary.

## Key Features

- Brand new home
- Family owned park
- Fully furnished
- Over 50's
- Part exchange available
- Pet-friendly
- Residential development
- Rural location
- Shops and amenities nearby
- Walk-in wardrobes

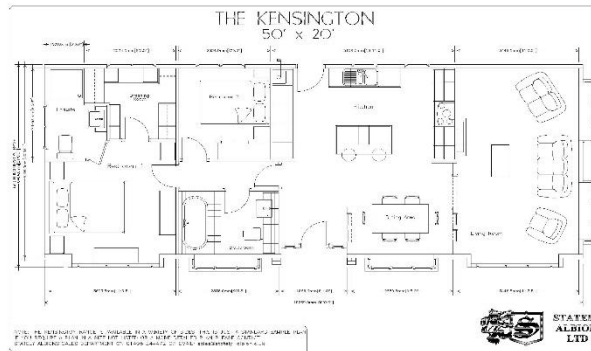

## House to sell?

Hassle-free Property Part-Exchange is available from Quickmove Properties, with no estate agent fees, no solicitor's fees and no market uncertainty.

## CONTACT US

01793 840917

advice@quickmoveproperties.co.uk

**Quickmove**  
PROPERTIES

