

# Ross-on-Wye, Herefordshire, HR9



£164,950



This brand new, fully furnished modern park home (34x20) is perfect for those looking for a detached, easy to maintain, bungalow-style retirement property. The home features a garden area and private parking. With a modern kitchen with integrated appliance, the home also features two good sized bedrooms.

The village itself has all essential amenities including a village shop, church, village hall, garage, post office and pub. There is also a regular bus service which travels to the surrounding local areas. The market town of Ross-on-Wye is the nearest main town where you will find a wide variety of shops, restaurants, and things to do. The city of Gloucester is just a short drive away.

Age restriction: Over 50's  
 Pet friendly: Yes  
 Site fees: £174.30  
 Residential license

Stock images have been used, the home on site may vary.

### Key Features

- Beautiful view
- Bus stop nearby
- Close to public transport
- Community living
- Over 50's
- Parking and garden
- Part exchange available
- Rural location
- Semi-rural location
- Shops and amenities nearby

Tredegar Elite 40 x 20

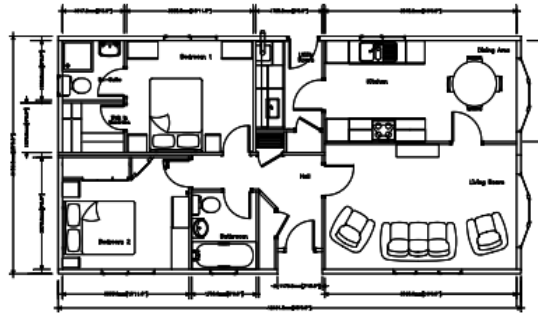

### House to sell?

Hassle-free Property Part-Exchange is available from Quickmove Properties, with no estate agent fees, no solicitor's fees and no market uncertainty.

### CONTACT US

01793 840917

[advice@quickmoveproperties.co.uk](mailto:advice@quickmoveproperties.co.uk)

