

# Warboys, Cambridgeshire, PE28



£150,000



A delightfully presented pre-owned two double bedroom detached park home (32x20) which the current owners have updated and should be viewed to fully appreciate the home. There has been a conservatory added to the rear of the home which backs onto fields and there is residents parking close by.

Located in the centre of the popular village of Warboys, you'll find lots of local amenities within walking distance such as a chemist, bakery, convenience store and many more. The park is located south of Peterborough, where you can find high street shops, plenty of restaurants and amenities.

Age restriction: Over 55s

Pet friendly: Cats only

Site fees: £2098.72 per year (paid monthly)

Residential license

### Key Features

- Backing Onto Fields
- Double glazing
- Excellent Condition
- Integrated Conservatory
- Residents Parking
- Over 55s
- Cat friendly
- Community living
- Countryside views
- Pre-owned home

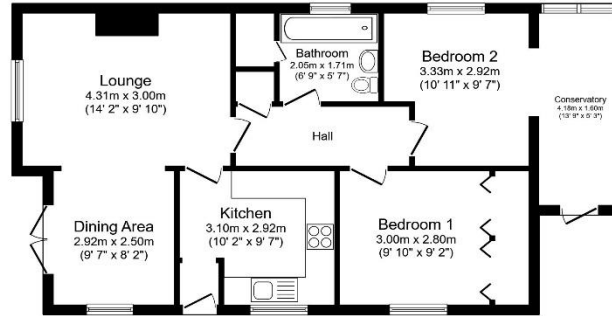

Total floor area 71.9 sq.m. (774 sq.ft.) approx

This floor plan is for illustrative purposes only. It is not drawn to scale. Any measurements, floor areas (including any total floor area), openings and orientation are approximate. No details are guaranteed. They cannot be relied upon for any purpose and they do not form part of any agreement. No liability is taken for any error, omission or misstatement. A party must rely upon its own inspection(s). Powered by www.floorplan.com



### House to sell?

Hassle-free Property Part-Exchange is available from Quickmove Properties, with no estate agent fees, no solicitor's fees and no market uncertainty.

### CONTACT US

01793 840917

advice@quickmoveproperties.co.uk

