

# Bude, Cornwall, EX23



£225,000





This pre-owned, well-kept park bungalow (42x14) is perfect for those looking for a detached, easy to maintain, bungalow-style retirement property. With lovely countryside views, the home features a modern, open plan kitchen, living room and diner with French doors leading to a patio, one double bedroom with a walk-in wardrobe and an ensuite with a bathtub, and a second twin bedroom. The front door patio has also been extended.

This residential development by RoyaleLife is exclusive for the over 45's, in stunning surroundings and within a mile of Widemouth Bay. The location is ideal for making the most of coastlines, offering walks, sandy landscapes, and unforgettable sunsets. An excellent base for exploring the treasures of the Cornish coastline, with Bude only 3 miles away.

Age restriction: Over 45's  
 Pet friendly: Yes  
 Site fees: £225 per month  
 Residential license

### Key Features

- En-suite with a bath
- Fully fitted kitchen
- Luxury 2 bed park bungalow
- On site facilities
- Over 45's
- Parking space
- Pet-friendly
- Home built in 2021
- Prestigious RoyaleLife development
- Residential park

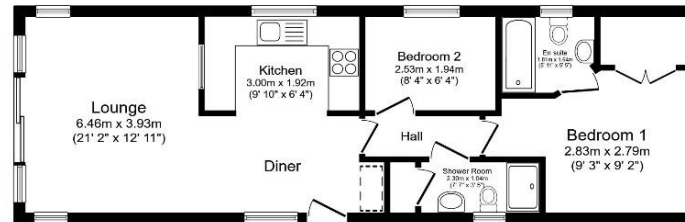

Total floor area 51.3 sq.m. (552 sq.ft.) approx

This floor plan is for illustrative purposes only. It is not drawn to scale. Any measurements, floor areas (including any total floor area), openings and orientation are approximate. No details are guaranteed. They cannot be relied upon for any purpose and they do not form part of any agreement. No liability is taken for any error, omission or misstatement. A party must rely upon its own inspection(s). Powered by www.localagent.com



### House to sell?

Hassle-free Property Part-Exchange is available from Quickmove Properties, with no estate agent fees, no solicitor's fees and no market uncertainty.

### CONTACT US

01793 840917

advice@quickmoveproperties.co.uk

