

# Poole, Dorset, BH16



£265,000



This pre-owned, modern park bungalow (40'x20') is perfect for those looking for a detached, easy to maintain, bungalow style retirement property. The home is in a good condition and features a modern kitchen and lounge/diner area. It has two double bedrooms and the master bedroom with en-suite shower room. The home has a small garden area, a raised patio and private driveway.

This RoyaleLife development is incredibly convenient due to easy access into neighbouring towns; Poole, Bournemouth, and Salisbury, as well as the New Forest and Hartland Moor National Nature Reserve which offer wonderful walking trails. The residents have access to a coffee lounge and have fishing rights to the lakes on the development.

Age restriction: Over 45's  
 Pet friendly: Yes (2 per home)  
 Site fees: £3156 per year  
 Residential license

### Key Features

- Integrated appliances
- Part exchange available
- Pets welcome
- Pre-loved park home
- Coffee lounge
- RoyaleLife development
- Private, gated development
- Residential development
- Over 45's

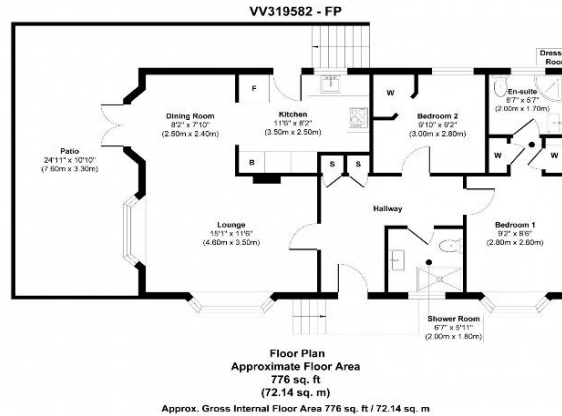

**House to sell?**

Hassle-free Property Part-Exchange is available from Quickmove Properties, with no estate agent fees, no solicitor's fees and no market uncertainty.

### CONTACT US

01793 840917

[advice@quickmoveproperties.co.uk](mailto:advice@quickmoveproperties.co.uk)

