

Milford-On-Sea, Hampshire, SO41



£335,000



This brand new, modern-furnished Pathfinder Lighthouse park bungalow (42'x20') is perfect for those looking for a detached, easy to maintain, bungalow-style retirement property. The home features comfortable living and kitchen areas with large windows, modern furniture, and two double bedrooms.

Bordered on one side by the New Forest and the other side by Christchurch Harbour, Milford on Sea is one of the last remaining seaside villages in Hampshire. Perched on the cliff-tops with stunning sea views, Milford on Sea is a natural beauty spot enjoyed by many and at all times of year. The area is popular with walkers, gentle strolls can be enjoyed along the Solent Coastal Path not to mention the wonderful expanse of the New Forest National Park which is a short drive away.

Age restriction: Over 45s

Pet friendly: Yes (2 per home)

Site fees (at time of listing): £257.50 per month

Residential license

Stock images have been used, the home on-site may vary.

Key Features

- Brand new home
- Coastal Location
- Community Living
- Fully Fitted Kitchen
- Viewings available
- Over 45's
- Part Exchange Available
- Pet-friendly
- Private
- Gated Development

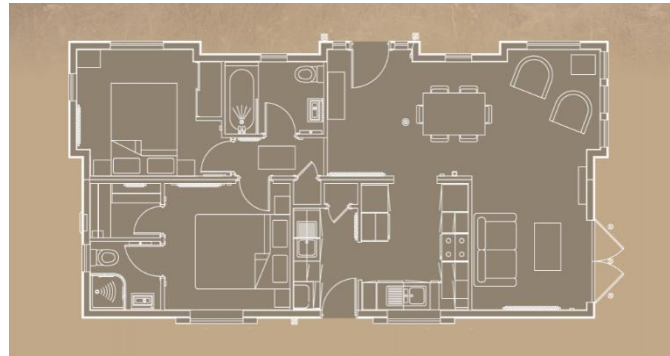

House to sell?

Hassle-free Property Part-Exchange is available from Quickmove Properties, with no estate agent fees, no solicitor's fees and no market uncertainty.

CONTACT US

01793 840917

advice@quickmoveproperties.co.uk

Quickmove
PROPERTIES

