

Newton Abbot, TQ12

Quickmove
PROPERTIES



£180,000

 x 2  x 1

THE HOME

This pre-owned, modern-furnished luxury park home (45'x14' Stately Albion Wentwood) is perfect for those looking for a detached, easy to maintain, bungalow style retirement property. The landscaped exterior has a garden area and parking space. The home features a modern, fitted kitchen, living room with luxury furniture, two bedrooms and a bathroom.

THE PARK

Regency Court is a modern RoyaleLife development of detached homes, with a 12-month leisure license. It has a wonderful rural location with excellent transport links and nearby shopping and amenities.

ABOUT THE AREA

The park is located in a good spot for enjoying the Devon countryside. Stover Country Park contains over 114 acres of woodland, heathland, a lake and a sensational variety of wildlife.

- Shop - 1.5 miles
- Post Office - 1.5 miles
- Nearest Supermarket - 3.5 miles
- GP Surgery - 3.5 miles
- Nearest Train Station - 4 miles
- Trago Mills - 2 minutes drive
- Dartmoor National Park - 5 minutes drive
- Stover Golf Club - 5 minutes walk
- Becky Falls Ancient Woodland Park - 16 minutes drive
- Torquay - 30 minutes drive

Site fees (at time of listing): £212.73 per month

Tenure: Leasehold

Pet Friendly: Yes

Age Restriction: Over 45's

Key Features

- Pre-owned 12 month holiday leisure bungalow
- Community Living
- En suite
- Established park
- High Specification
- Fully furnished
- Modern Design
- Over 45s
- Parking
- Pets welcome

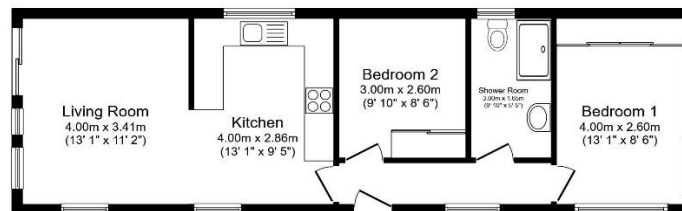

CONTACT US

01793 840917

advice@quickmoveproperties.co.uk

Quickmove
PROPERTIES

