

# Dumfries, Dumfriesshire, DG2

**Quickmove**  
PROPERTIES



£77,500

 x 2

 x 1

This pre-owned, well-maintained bespoke (42'x13') park home is perfect for those looking for a detached, easy-to-maintain, bungalow-style property. The home features a modern kitchen, a living room with French doors, two bedrooms and a family bathroom. The exterior features a garden space, decking and driveway.

This park is located in the countryside of South-West Scotland, less than 10 miles from some beautiful, quiet beaches. This rural region of Scotland has one of the lowest populations in the UK - around 140,000 - and offers 2,400 square miles of stunning, unspoilt scenery, from rolling countryside and rugged coastline to forests, lochs, and the Galloway Hills.

Age restriction: Over 45s

Pet friendly: Yes

Site fees: £160 per month

Residential license

### Key Features

- Countryside location
- Over 45's
- Part Exchange Available
- Pet-friendly
- Pre-owned park home
- Private
- Gated Development
- Residential Development
- Two Bedrooms
- Well maintained home

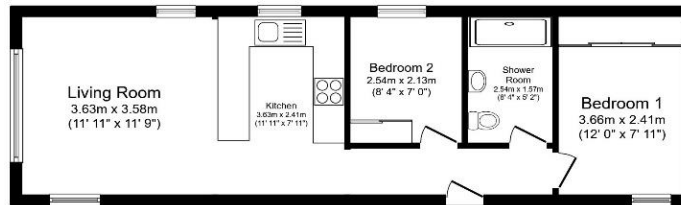

Total floor area 45.2 sq.m. (486 sq.ft.) approx

This floor plan is for illustrative purposes only. It is not drawn to scale. Any measurements, floor areas (including any total floor area), openings and orientation are approximate. No details are guaranteed, they cannot be relied upon for any purpose and they do not form part of any agreement. No liability is taken for any error, omission or misstatement. A party must rely upon its own inspection(s). Powered by [www.floorplaner.com](http://www.floorplaner.com)



### House to sell?

Hassle-free Property Part-Exchange is available from Quickmove Properties, with no estate agent fees, no solicitor's fees and no market uncertainty.

### CONTACT US

01793 840917

[advice@quickmoveproperties.co.uk](mailto:advice@quickmoveproperties.co.uk)

