

Tranquility Park, Woolacombe, Devon, EX34

Quickmove
PROPERTIES



£279,950

 x 2

 x 2

This pre-owned home is perfect for those looking for a detached, easy to maintain, bungalow style retirement property in a modern development. An exceptional home located in a prominent position on the park offering breathtaking views. The home is a 45'x18' Omar Elveden Cottage design with a wrap-around deck, modern kitchen, study and two double bedrooms.

Set in the rolling hills of North Devon, this modern and welcoming residential park for the over 45s is within walking distance from Woolacombe Bay. A bus stop is located just outside of the park, providing great transport links to the surrounding area. The village of Woolacombe is just a short walk away, there you can find your local amenities as well as pubs, restaurants, and leisure activities.

Age restriction: Over 45s

Pet friendly: Yes

Site fees: £308.56 per month

Residential license

House to sell?

Hassle-free Property Part-Exchange is available from Quickmove Properties, with no estate agent fees, no solicitor's fees and no market uncertainty.

Key Features

- Coastal Location
- Countryside Views
- Decking
- Part Exchange Available
- Pet-friendly
- Pre-owned park home
- Residential Development
- Two Double Bedrooms
- Very good condition
- Well maintained home

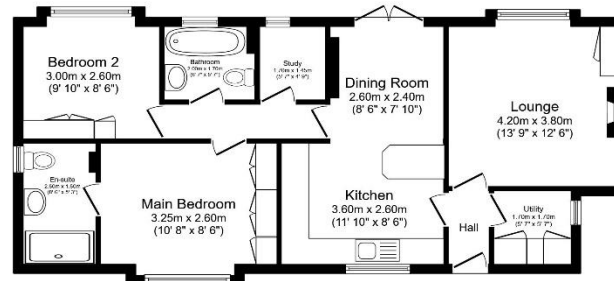

Total floor area 71.7 sq.m. (772 sq.ft.) approx

This floor plan is for illustrative purposes only. It is not drawn to scale. Any measurements, floor areas (including any total floor area), openings and orientation are approximate. No details are guaranteed. They cannot be relied upon for any purpose and they do not form part of any agreement. No liability is taken for any error, omission or misstatement. A party must rely upon its own inspection(s). Powered by www.bonapart.com



CONTACT US

01793 840917

advice@quickmoveproperties.co.uk

Quickmove
PROPERTIES

