

# Upminster, Essex, RM14

**Quickmove**  
PROPERTIES



£170,000



This brand new, modern-furnished Omar Southwold (40'x14') luxury park home is perfect for those looking for a detached, easy to maintain, bungalow-style property. The home features an open plan kitchen and living area, with French doors leading to a decking, there is also one large double bedroom with an en suite. The landscaped exterior boasts decking and parking.

This family-run leisure development consists of just 8 homes across 2.2 acres. The development is gated and offers maintained and landscaped grounds. The leisure park is exclusive for the over 50s and is pet friendly. Next door to the park is a working farm, which sells produce.

Upminster town is 3 miles away, with a popular high street and a train station. The beautiful Thorndon Park with its extensive woods, horse trails and bike trails is within a 5-minute drive. Within 10 minutes drive is the Lakeside Shopping Mall. A little further afield are Bluewater Shopping Centre and Basildon Festival Park which all have a vast array of shops, restaurants, and cinemas. 30 minutes drive is the popular seaside town of Southend-on-Sea.

Age restriction: Over 50s  
 Pet friendly: Yes  
 Site fees: £291 per month  
 10 month leisure license

### Key Features

- 10 month leisure license
- Brand new home
- Fully Furnished
- Landscaped Park
- Over 50s
- Parking space
- Pet-Friendly
- Private, Gated Development
- Semi-Rural Location

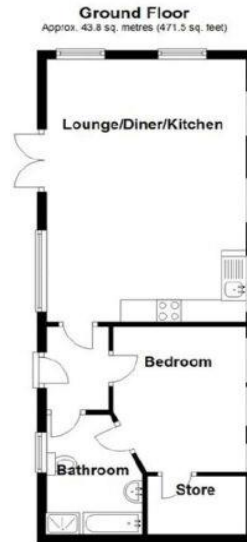

Total area: approx. 43.8 sq. metres (471.5 sq. feet)

FOR ILLUSTRATIVE PURPOSES ONLY. NOT TO SCALE. While every attempt has been made to ensure the accuracy of the floorplan shown, all measurements, positioning, fixtures, fittings and any other data shown are an approximate interpretation for illustrative purposes only and are not to scale. No responsibility is taken for any error, omission, misstatement or use of data shown B.S.B. (UK) LTD  
 Plan produced using PlanUp.



## CONTACT US

01793 840917

advice@quickmoveproperties.co.uk

