

Newport, Isle of Wight, PO30



£195,000



This brand new, modern-furnished Willerby Kingswood (40'x20') luxury park home is perfect for those looking for a detached, easy to maintain, bungalow-style property. The home features a kitchen with integrated appliances, dining area, a comfortable living room, two bedrooms and two bathrooms.

Located in a central position on the Isle of Wight, this brand-new residential development is exclusive for the over 45s. It is also pet friendly, gated, and has CCTV to provide extra privacy and security. Residents can have their own sheds with the park owner's agreement, and each home has 2 parking spaces.

The park is located in an ideal position, surrounded by countryside and greenery but just a 5-minute walk from the nearby town of Newport. The nearest supermarket and golf course are also within walking distance. The Isle of Wight is a designated Area of Outstanding Natural Beauty, with many walking trails, cycle routes and beaches to explore.

Age restriction: Over 45

Pet friendly: Yes

Site fees: £2,950 per year

Stock Images have been used, the home on site may vary

Key Features

- Brand new home
- CCTV Security System
- Close To Nearby Amenities
- Fully Furnished
- Landscaped grounds
- Over 45s
- Part Exchange Available
- Pet-Friendly
- Private, Gated Development

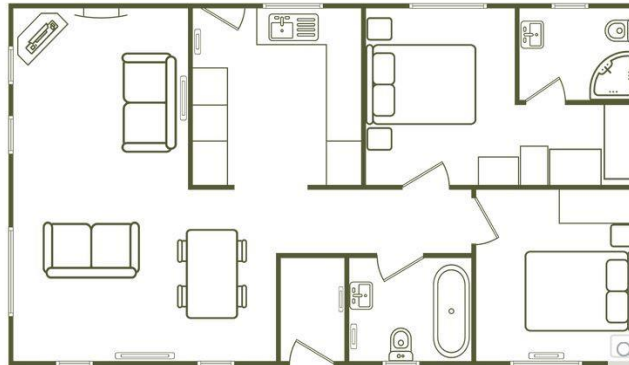

CONTACT US

01793 840917

advice@quickmoveproperties.co.uk

Quickmove
PROPERTIES

