

Mansfield, Nottingham, NG19

Quickmove
PROPERTIES



£98,000

 x 2

 x 2

This brand new, modern-furnished ABI Ingleton (40'x13') luxury park home is perfect for those looking for a detached, easy to maintain, bungalow-style property. The home features an open plan layout, two bedrooms, an en suite and a bathroom with two parking spaces outside, with additional options for decking and paving.

This 12-month leisure development of 78 lodges is located in a lovely semi-rural location, one mile from Mansfield. Set in 7 acres, the park features a launderette, children's play area and fishing lake. Dogs are welcome and a bus stop is at the entrance of the park. There is also CCTV and a barrier at the park entrance for added security. At the back of the park is the Maun Valley Nature trail which takes you along the river and into Sherwood.

The park is less than one mile from Mansfield town centre and within walking distance of a pub and shops. Sherwood Forest is 5 miles away, a national nature reserve over 1,000 acres. Nottingham city centre is 15 miles away where you can find high street shops and city amenities.

Age restriction: None

Pet friendly: Yes

Site fees: £2,732 per year

Stock images have been used, the home on site may vary.

House to sell?

Hassle-free Property Part-Exchange is available from Quickmove Properties, with no estate agent fees, no solicitor's fees and no market uncertainty.

Key Features

- 12 Month Leisure Licence
- Brand new home
- CCTV at park entrance
- Fully Furnished
- Integrated Appliances
- No age restriction
- Parking for two cars

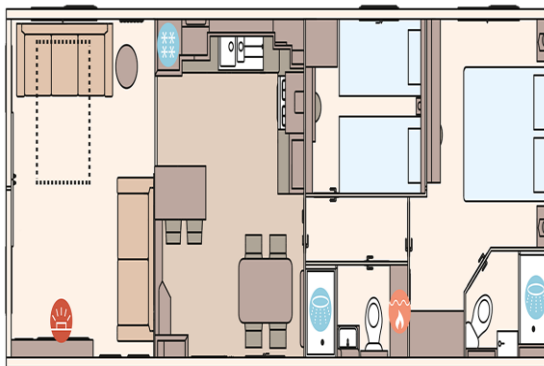

CONTACT US

01793 840917

advice@quickmoveproperties.co.uk

Quickmove
PROPERTIES

