

Coombe Park, Camborne, Cornwall, TR14

Quickmove
PROPERTIES



£120,000



This home has been extensively refurbished approx 6 years ago and a new boiler put in last year. There is a wooden and metal shed outside and off-street parking. The home was formally a two-bedroom home but now there is a study area off the master bedroom.

Coombe Park is located in a tranquil valley, with countryside views and a peaceful atmosphere. The park is located less than a mile from the Cornish coast, where residents can enjoy stunning beaches and the South West coastal path. Camborne town is a few miles away where you can find all of your amenities, including shops, restaurants, a train station and hotels. The development is located just down the road from a country park and a golf club.

Age restriction: Over 55s

Pet friendly: Yes

Site fees (at time of listing): £212.08 per month

Residential license

Key Features

- Community Living
- Driveway
- Garden space
- One Double Bedroom
- Over 55's
- Part Exchange Available
- Pet-friendly
- Pre-owned park home
- Well maintained home
- Coastal location

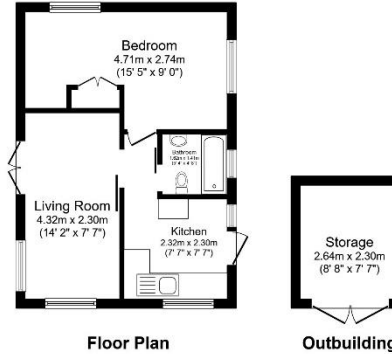

Total floor area 37.4 sq.m. (402 sq.ft.) approx

The floor plan is for illustrative purposes only. It is not drawn to scale. Any measurements, floor areas (including any total floor area), openings and orientation are approximate. No details are guaranteed. They cannot be relied upon for any purpose and they do not form part of any agreement. No liability is taken for any error, omission or misstatement. A party must rely upon its own inspection(s). Powered by www.foxagent.com



CONTACT US

01793 840917

advice@quickmoveproperties.co.uk

Quickmove
PROPERTIES

