

Fengate Park, Peterborough, Cambridgeshire, PE1



£112,500



This pre-owned Omar Regency (36'x12') park home is perfect for those looking for a detached, easy to maintain, bungalow style property. Built in 2022, this well-presented home features a modern fitted kitchen, living area, two bedrooms and a bathroom. The exterior has also been recently re-gravelled.

Fengate Park is well located with a bus stop outside the park. There is a fishing lake 2 miles from the park and the centre of Peterborough is only 1.5 miles away, with an abundance of shops and activities. The park is 55 minutes from London by train and there are good rail links with other major cities. Peterborough is also close to the A1 and A1/M1 link road.

Age restriction: Over 45s

Pet friendly: Yes

Site fees: £169 per month

Residential development

Council Tax Band A

Key Features

- Built in 2022
- Community Living
- Fishing lake nearby
- Over 45s
- Part Exchange Available
- Pre-owned park home
- Residential Development
- Shops and amenities nearby
- Two Bedrooms
- Well maintained home

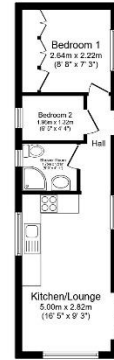

Total floor area 30.7 sq. m. (330 sq. ft.) approx

This floor plan is for illustrative purposes only. It is not drawn to scale. Any measurements, floor areas (including any total floor area), openings and elevations are approximate. No details are guaranteed, they cannot be relied upon for any purpose and they do not form part of any agreement. No liability is taken for any error, omission or misstatement. A party must rely upon its own inspection(s). Powered by www.floorplan.com



House to sell?

Hassle-free Property Part-Exchange is available from Quickmove Properties, with no estate agent fees, no solicitor's fees and no market uncertainty.

CONTACT US

01793 840917

advice@quickmoveproperties.co.uk

Quickmove
PROPERTIES

