

Andover, Hampshire, SP11



£289,000



This brand new modern-furnished luxury Prestige Majestic park home (42'x20') is perfect for those looking for a detached, easy to maintain, bungalow-style property. The home has a modern kitchen with integrated appliances, living and dining area, two double bedrooms, an en suite and a bathroom. The home has private gardens, paved patio and driveway.

Exclusive for over 45's, this established, landscaped development is in the stunning landscape of the Hampshire Downs, overlooking the Test Valley. Next door is the award-winning Wyke Down Country Pub and Restaurant offering real ales and homemade food with exclusive discounts for residents. The market town of Andover is just 2 miles from the park and hosts a wide range of amenities, shops, restaurants, and frequent direct trains into London Waterloo.

Age restriction: Over 45s
 Pet friendly: Yes (2 per home)
 Site fees: £795 per quarter
 Residential license
 Stock images have been used.

Key Features

- Brand new home
- Fully Furnished
- Garage
- Garden space
- Modern Fitted Kitchen
- Over 45s
- Part Exchange Available
- Private Decking
- Private, Gated Development

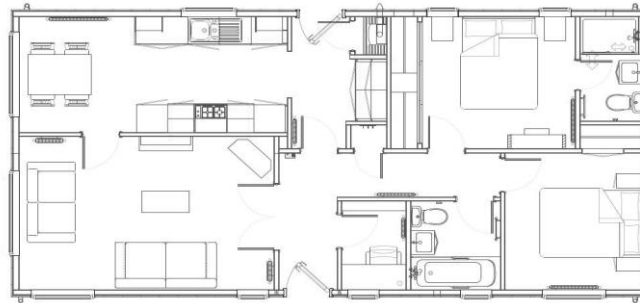

House to sell?

Hassle-free Property Part-Exchange is available from Quickmove Properties, with no estate agent fees, no solicitor's fees and no market uncertainty.

CONTACT US

01793 840917

advice@quickmoveproperties.co.uk

