

# Sheffield, Derbyshire, S21

**Quickmove**  
PROPERTIES



£169,950

 x 2

 x 1

This pre-owned, modern luxury park home (752 sq. ft.) is perfect for those looking for a detached, easy-to-maintain, bungalow-style property. The home has a kitchen and dining area, separate living room with an electric fireplace and doors leading to the garden. There are two double bedrooms with fitted wardrobes and a family bathroom with a bathtub and a walk-in shower. The landscaped exterior boasts a private garden area and driveway.

Located less than 10 miles from the centre of Sheffield, this park is well located for enjoying the rural village lifestyle while not being far from city amenities and facilities. Marsh Lane Village is a small community with a local pub and good bus routes to the surrounding area. Chesterfield is also 6 miles from the park, this market town is home to supermarkets, train station, golf courses, high street shops and much more.

Age restriction: Over 50s  
 Site fees: £470 per month  
 Pet friendly: Yes  
 Residential license

### Key Features

- Community Living
- Garden space
- Over 50s
- Part Exchange Available
- Pet-Friendly
- Pre-owned park home
- Two Bedrooms
- Well maintained
- Vacant home

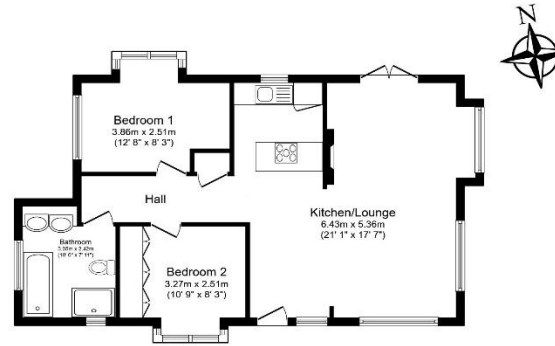

Total floor area 69.9 m<sup>2</sup> (752 sq.ft.) approx

This floor plan is for illustrative purposes only. It is not drawn to scale. Any measurements, floor areas (including any total floor area), openings and orientation are approximate. No details are guaranteed, they cannot be relied upon for any purpose and they do not form part of any agreement. No liability is taken for any error, omission or misstatement. A party must rely upon its own inspection(s). Powered by [www.housesagent.com](http://www.housesagent.com)



### CONTACT US

01793 840917

[advice@quickmoveproperties.co.uk](mailto:advice@quickmoveproperties.co.uk)

