

# Swanage, Dorset, BH19



Price as listed



This brand new, modern-furnished Pathfinder Lighthouse (40'x20') luxury park home is perfect for those looking for a detached, easy to maintain, bungalow-style retirement property. The home features a fully fitted kitchen with integrated appliances, a comfortable living area with modern furniture, two bedrooms and two bathrooms.

This home is located on a brand-new development of around 100 residential park homes. The park is in a 14-acre setting among the Purbeck Hills with outstanding views of the beautiful Dorset countryside yet only 15 minutes walk to Swanage Town Centre and Beach. This residential park has been developed for people 50 and over and pets can be considered.

Age restriction: Over 50s

Pet friendly: Yes (2 per home)

Site fees (at time of listing): £260 per month

Residential license

### Key Features

- 15 minute walk from beach
- Brand new home
- Community Living
- Exceptionally High Specification
- Two bedrooms
- Fully Furnished
- Over 50's
- Part Exchange Available
- Residential Park
- Modern home

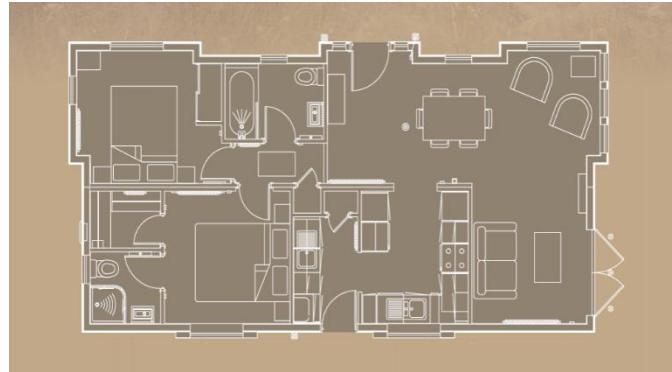

### House to sell?

Hassle-free Property Part-Exchange is available from Quickmove Properties, with no estate agent fees, no solicitor's fees and no market uncertainty.

### CONTACT US

01793 840917

[advice@quickmoveproperties.co.uk](mailto:advice@quickmoveproperties.co.uk)

**Quickmove**  
PROPERTIES

