

Birchington, Kent, CT7

Quickmove
PROPERTIES



Price as listed

 x 2

 x 1

This pre-owned Omar Suffolk (50'x12') is perfect for those looking for a detached, easy to maintain, bungalow-style property. The home has a spacious kitchen and dining room, with integrated appliances and an external door, a living room, two double bedrooms and a bathroom. The home has a private garden space with a brick shed.

This residential development is situated in the convenient seaside village of Birchington. The park is beautifully landscaped and has some beautiful water gardens and an abundance of tropical plants, palm trees and 18th-century Italian statues. The seaside village of Birchington with its high street of shops, post office, pubs and restaurants, dentist and doctors a short stroll from the park.

Age restriction: Over 55s

Site fees (at time of listing): £290.89 per month
Residential license

House to sell?

Hassle-free Property Part-Exchange is available from Quickmove Properties, with no estate agent fees, no solicitor's fees and no market uncertainty.

Key Features

- CCTV on park
- Coastal Location
- Community Living
- Enclosed Garden
- Excellent Transport Links
- Over 55's
- Part Exchange Available
- Residential Development
- Two bedrooms

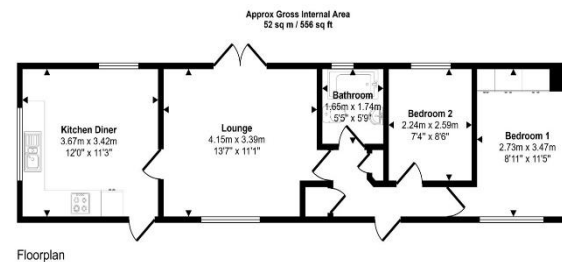

Whilst every attempt has been made to ensure the accuracy of the floor plan contained here, measurements of doors, windows, rooms and any other items are approximate and no responsibility is taken for any error, omission, or mis-statement. The measurements should not be relied upon for valuation, transaction and/or funding purposes. This plan is for illustrative purposes only and should be used as such by any prospective purchaser or tenant.



CONTACT US

01793 840917

advice@quickmoveproperties.co.uk

Quickmove
PROPERTIES

