

# Poole, Dorset, BH16

**Quickmove**  
PROPERTIES



£180,000





This pre-owned, modern Tingdene Cosgrove (45'x14') park home is perfect for those looking for a detached, easy to maintain, bungalow style property. The home has a kitchen and dining room with integrated appliances, living room with French doors leading out to the garden, a double bedroom with fitted wardrobes, a single bedroom and a shower room. The home has a driveway and garden space.

This home is located on a private, gated development in a wooded elevated setting with a private fishing lake on site. The development is convenient due to easy access to neighbouring towns including the traditional town of Wimborne, Poole, and Bournemouth, as well as surrounding country parks including the New Forest and Hartland Moor National Nature Reserve which offer wonderful walking trails.

Age restriction: Over 45s  
 Pet friendly: Yes (2 per home)  
 Site fees: £321 per month  
 Residential license

### House to sell?

Hassle-free Property Part-Exchange is available from Quickmove Properties, with no estate agent fees, no solicitor's fees and no market uncertainty.

### Key Features

- Garden space
- Integrated Appliances
- Over 45s
- Part Exchange Available
- Pets welcome
- Pre-owned park home
- Private, Gated Development
- Residential Development
- Residents' Coffee Lounge

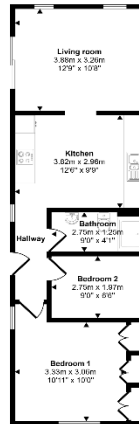

### CONTACT US

01793 840917

[advice@quickmoveproperties.co.uk](mailto:advice@quickmoveproperties.co.uk)

**Quickmove**  
 PROPERTIES

