

# Jaywick, Essex, CO16



Price as listed



This brand new, modern-furnished Manor Arthingworth park home (42'x20') is perfect for those looking for a detached, easy to maintain, bungalow-style retirement property. The home has a modern kitchen and diner, a lounge, two double bedrooms with fitted furniture, an en-suite bathroom and a bathroom.

Combining the calm of coastal living with the relaxation of rural life, this new development will consist of 104 homes with views over the countryside. The development is exclusive for the over 45s.

This brand new development is located in the countryside, a short distance from the seaside town of Clacton, and within great reach of the wider delights of Essex and Suffolk.

Age restriction: Over 45s

Pet friendly: Yes

Site fees (at time of listing): £207 per month

Residential license

### House to sell?

Hassle-free Property Part-Exchange is available from Quickmove Properties, with no estate agent fees, no solicitor's fees and no market uncertainty.

### Key Features

- Brand new home
- Coastal Location
- Community Living
- Fully Furnished
- Part Exchange Available
- Residential Development
- Over 45s
- Pet friendly
- Modern home
- Two bedrooms

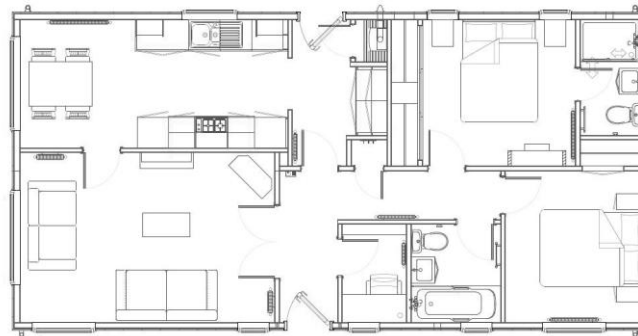

### CONTACT US

01793 840917

[advice@quickmoveproperties.co.uk](mailto:advice@quickmoveproperties.co.uk)

**Quickmove**  
PROPERTIES

