

Beverley, Yorkshire, HU17



Price as listed



This pre-owned, well maintained (38'x12') park home is perfect for those looking for a detached, easy-to-maintain, bungalow-style property. The home has a kitchen, dining area and living room, one double bedroom with storage, a second single bedroom and a shower room. The home also has a low maintenance garden space.

The park is located just outside the small town of Leven, where you can find a handful of shops and pubs. Beverley is 7 miles from the development, where you can find further town amenities including supermarkets, and a train station. Hornsea Beach is less the 10 miles down the road, where you can enjoy a traditional seaside atmosphere.

Age restriction: Over 50s

Pet friendly: Yes

Site fees (at time of listing): £2,300 per year

Residential license

House to sell?

Hassle-free Property Part-Exchange is available from Quickmove Properties, with no estate agent fees, no solicitor's fees and no market uncertainty.

Key Features

- Community Living
- Garden space
- Over 50s
- Part Exchange Available
- Pet-Friendly
- Pre-owned park home
- Residential Development
- Town facilities nearby
- Two Bedrooms
- Well maintained home

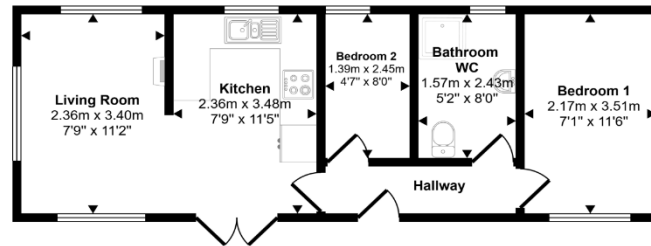

CONTACT US

01793 840917

advice@quickmoveproperties.co.uk

Quickmove
PROPERTIES

