

# Bordon, Hampshire, GU35



Price as listed



This brand new, modern furnished Prestige Avanti (45'x20') park home is perfect for those looking for a detached, easy to maintain, bungalow-style property. The home has a modern kitchen with integrated appliances, and a living and dining room. There is a study, the master bedroom has a walk in wardrobe and en suite, there is a second double bedroom and a bathroom.

The park is surrounded by stunning countryside in a beautiful corner of East Hampshire. While the setting is secluded and peaceful, you're also close to the hustle and bustle of larger towns such as Camberley, Basingstoke, Guildford and the charming market towns of Alton and Petersfield.

Age restriction: Over 45s

Pet friendly: Yes

Site fees: £295.76 per month

Residential license

## Key Features

- Brand new home
- Community Living
- Garden space
- Over 45s
- Part Exchange Available
- Pet-Friendly
- Private, Gated Development
- Residential Development
- Two Double Bedrooms

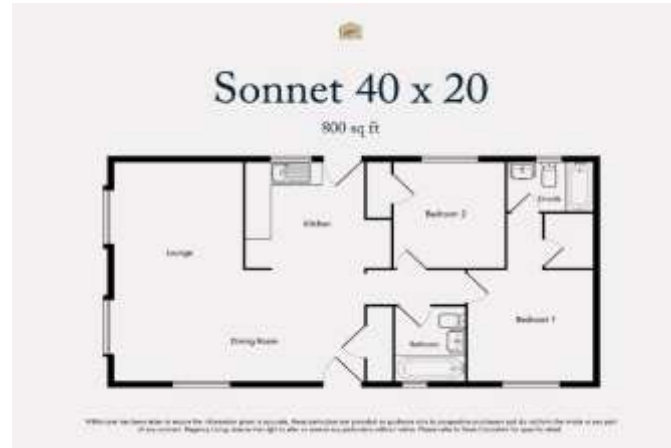

## House to sell?

Hassle-free Property Part-Exchange is available from Quickmove Properties, with no estate agent fees, no solicitor's fees and no market uncertainty.

## CONTACT US

01793 840917

[advice@quickmoveproperties.co.uk](mailto:advice@quickmoveproperties.co.uk)

**Quickmove**  
PROPERTIES

