

# Newport, Isle of Wight, PO30



Price as listed



This brand new, modern-furnished Prestige Majestic (44'x20') luxury park home is perfect for those looking for a detached, easy to maintain, bungalow-style property. The home features a kitchen with integrated appliances, dining area, a comfortable living room, two double bedrooms and two bathrooms. The home has a driveway with parking for two cars.

Located in a central position on the Isle of Wight, this brand-new residential development is gated, and has CCTV to provide extra privacy and security. Residents can have their own sheds with the park owner's agreement, and each home has 2 parking spaces.

The park is located in an ideal position, surrounded by countryside and greenery but just a 5-minute walk from the nearby town of Newport. The nearest supermarket and golf course are also within walking distance. The Isle of Wight is a designated Area of Outstanding Natural Beauty, with many walking trails, cycle routes and beaches to explore.

Age restriction: Over 45's

Pet friendly: Yes

Site fees: £2,950 per year

Stock images have been used, the home on site may vary

### House to sell?

Hassle-free Property Part-Exchange is available from Quickmove Properties, with no estate agent fees, no solicitor's fees and no market uncertainty.

### Key Features

- Brand new home
- CCTV
- Close to nearby amenities
- Fully furnished
- Landscaped grounds
- Over 45s
- Part Exchange available
- Pet friendly
- Private, gated development

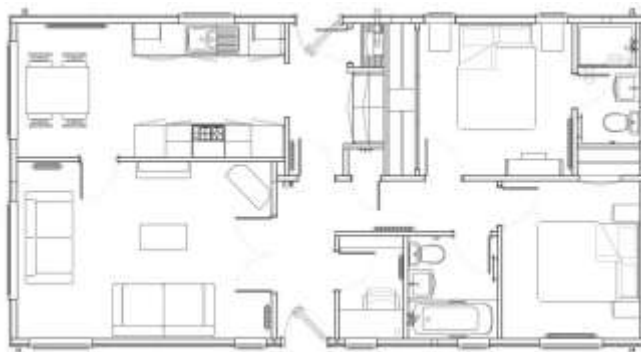

### CONTACT US

01793 840917

[advice@quickmoveproperties.co.uk](mailto:advice@quickmoveproperties.co.uk)

**Quickmove**  
PROPERTIES

