

Delabole, Cornwall, PL33



Price as listed



x 2



x 1

This pre-owned, Oakwood Poplar (40'x12') park home is perfect for those looking for a detached, easy to maintain, bungalow style property. The home has an open plan kitchen and living area, a shower room, one double bedroom with fitted wardrobes and a second bedroom. The home has an easy to maintain garden space and a driveway with a large shed.

The park is well located for making the most of the Cornish coastline. It is on the edge of the village of Delabole with villages such as Rock, Polzeath, and Port Isaac and the North Cornish coastal resorts of Tintagel, Boscastle, Widemouth Bay and Bude all within easy reach by car, public transport and by foot for those who are into walking.

Age restriction: Over 50s

Pet friendly: Yes

Site fees (at time of listing): £205.11 per month

Residential license

Key Features

- Garden space
- Modern design
- Over 50s
- Part Exchange available
- Pre-owned park home
- Residential development
- Two bedrooms
- Well maintained home
- Driveway

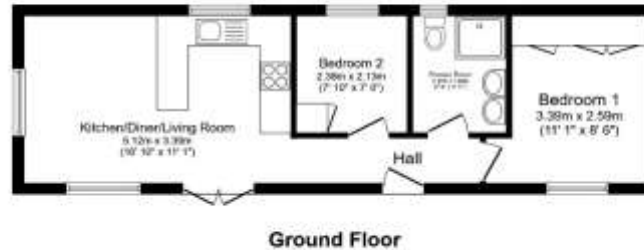

House to sell?

Hassle-free Property Part-Exchange is available from Quickmove Properties, with no estate agent fees, no solicitor's fees and no market uncertainty.

CONTACT US

01793 840917

advice@quickmoveproperties.co.uk

